



# Floor Insulation

## Installation Guide – Below Ground Slab

### Preparation

The ground should be excavated to the desired level and the soil or hardcore base must be compacted and levelled with sand.

Sundolitt EPS Floor Insulation may be placed above or below the concrete ground bearing slab. The insulation should always be placed between a Damp Proof Membrane (DPM) and Vapour Control Layer (VCL).

### Damp Proofing

Sand blinding over compacted hardcore or stony ground must be provided at least 50mm thick to protect the membrane against damage.

The DPM (minimum 1000g polythene sheet) is laid directly onto the prepared surface with all joints lapped and sealed to prevent water ingress.

The membrane is dressed up external walls and overlap with the damp proof course providing a continuous moisture barrier.

### EPS Insulation

The EPS insulation is laid over the DPM, tightly butting each board together, ensuring there are no gaps.

The boards are easily cut with a fine toothed saw to fit the space required.

A minimum 30mm thick EPS sheet is installed vertically to all external edges of the floor. This must overlap the wall insulation by at least 150mm to prevent cold bridging.

The vapour control layer (minimum 500g polythene sheet) is placed over the insulation boards with all joints lapped and sealed. The membrane should be dressed vertically over the floor edge insulation.

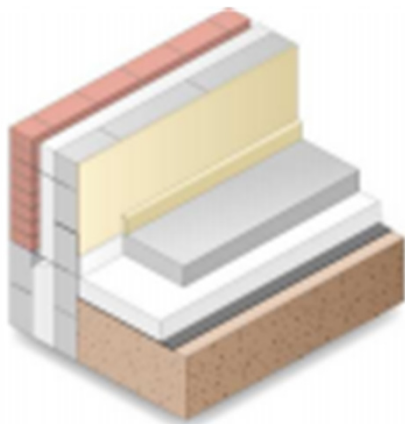

### Concrete Slab

Reinforcement must be placed onto suitable spacers to prevent puncturing the membrane and damaging the insulation.

The concrete slab may be poured or pumped over the insulation and VCL.

Care must be taken not to damage the VCL and insulation during installation of the concrete.

### Pipes and Services

Underfloor heating pipes may be clipped directly onto the insulation. Hot water pipes should be isolated from the insulation by 12mm as they may exceed the maximum working temperature of the insulation at 80°C.

Other services may be placed within the depth of the insulation ensuring continuation of insulation by providing a 30mm sheet above or below the service duct.

PVC sheathed electric cables should not be allowed direct contact with the EPS. They may be placed over the VCL membrane or installed in PVC conduit.

## CONTACT US

 01786 471586

 [enquiriesuk@sundolitt.com](mailto:enquiriesuk@sundolitt.com)

 [www.sundolitt.com](http://www.sundolitt.com)